

■Features

- High luminous Flux LEDs
- 4.8mm Straw Standard Directivity
- Superior Weather-resistance
- UV Resistant Epoxy
- Water Clear Type

■Applications

- Automotive Dashboard Lighting
- Traffic Signal Lamp
- Back Lighting
- Other Lighting

■Absolute Maximum Rating

(Ta=25°C)

| Item | Symbol | Value | Unit |
|----------------------------|------------------|------------|------|
| DC Forward Current | I _F | 60 | mA |
| Pulse Forward Current* | I _{FP} | 300 | mA |
| Reverse Voltage | V _R | 5 | V |
| Power Dissipation | P _D | 156 | mW |
| Operating Temperature | T _{opr} | -30 ~ +85 | °C |
| Storage Temperature | T _{stg} | -40~ +100 | °C |
| Lead Soldering Temperature | T _{sol} | 260°C/5sec | - |

*Pulse width Max.10ms Duty ratio max 1/10

■Outline Dimension

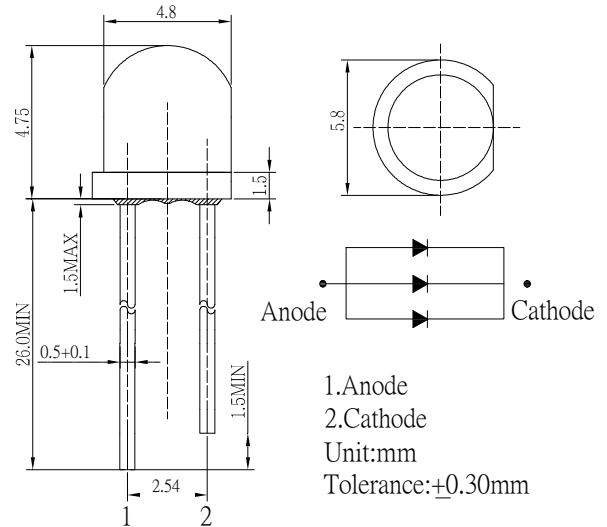

■Directivity

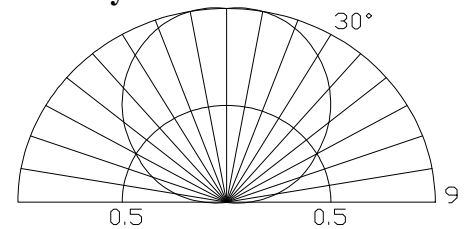

■Electrical -Optical Characteristics

(Ta=25°C)

| Item | Symbol | Condition | Min. | Typ. | Max. | Unit |
|--------------------|-------------------|----------------------|------|-------|------|------|
| DC Forward Voltage | V _F | I _F =60mA | 1.8 | 2.1 | 2.6 | V |
| DC Reverse Current | I _R | V _R =5V | - | - | 30 | μA |
| Domi. Wavelength | λ _D | I _F =60mA | 619 | 625 | 629 | nm |
| Luminous Intensity | I _v | I _F =60mA | 8400 | 10000 | - | mcd |
| 50% Power Angle | 2θ _{1/2} | I _F =60mA | - | 120 | - | deg |

*1 Tolerance of dominant wavelength is +1nm

*2 Tolerance of luminous intensity is +15%